



STRUCTURE ID: C410

Cast Iron Frame  
EJCO | 2805Z



Cast Iron Frame EJCO | 2805Z ... STRUCTURE ID : C410

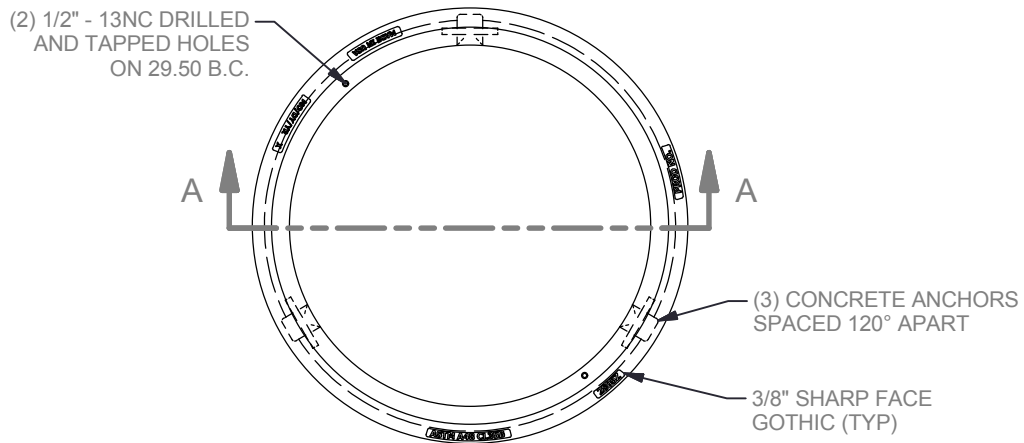

**PLAN VIEW**

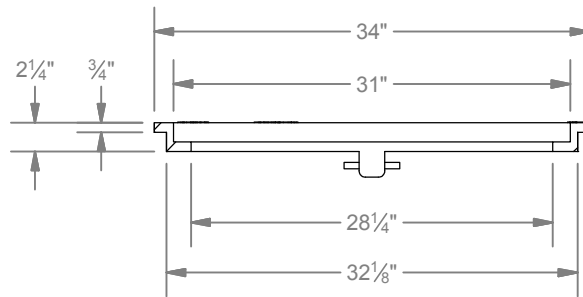

**SECTION A-A  
SCALE 1:15**

**STANDARD FEATURES**

- Materials Gray Iron (CL35B)
- Design Load Heavy Duty
- Coating Undipped
- ASTM A48

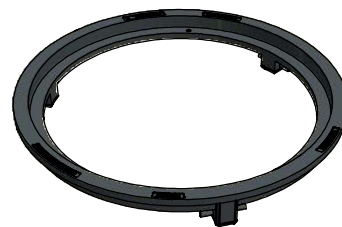

**LOCKE**  
SOLUTIONS

PROUDLY BASED IN  
HOUSTON, TEXAS

T : 832-804-7062  
F : 832-804-7071  
E : info@lockesolutions.com

[LOCKESOLUTIONS.COM](http://LOCKESOLUTIONS.COM)

